

SEALS

These seal rings are designed to ensure they locate perfectly in the housing bore without any other retaining facility (interference fit).

A number of factors have to be considered when selecting supplementary seals, for instance, the arrangement, design or available space. Furthermore, seals increase friction. This V-section seal consists of two wipers and performs two purposes. The inner wiper retains the lubricant in the bushing and the outer wiper protects the ball bushing against the ingress of particles.

Bellows type covers should be used if it is envisaged that quantities of dirt particles will be evident in the operating environment.

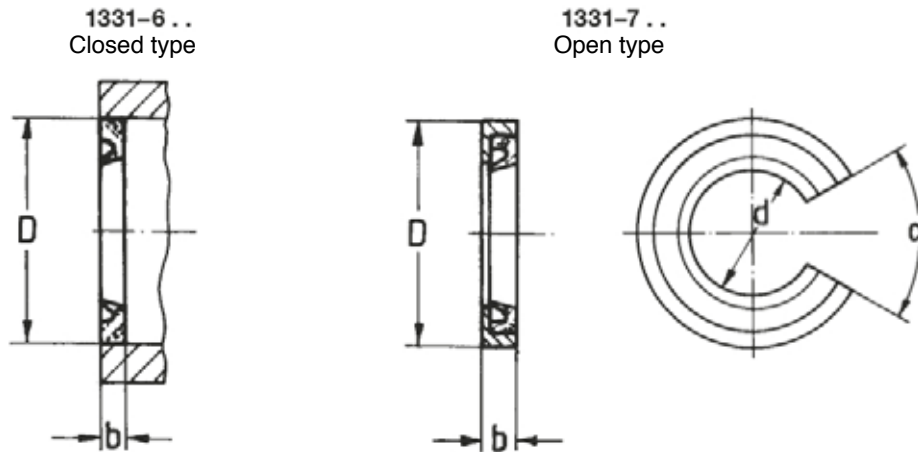

PART		d	D	b	α
CLOSED	OPEN				
1331-612		12	22	3	
	1331-712	12	22	5	68
1331-616		16	26	3	
	1331-716	16	26	5	
1331-620		20	32	4	
	1331-720	20	32	6	56
1331-625		25	40	4	
	1331-725	25	40	6	58
1331-630		30	47	5	
	1331-730	30	47	7	58
1331-640		40	62	5	
	1331-740	40	62	7	57
1331-650		50	75	6	
	1331-750	50	75	11	55